

Go for state-of-the-art.



swissmade 

The intuitive dial & dose disposable pen.

- Intuitive and proven dial and dose handling concept for maximum patient acceptance
- Easy dose setting and correction ensuring a high level of patient comfort
- State-of-the-art pen with optimal gearing to minimise the injection force
- For insulin and other multidose therapies
- Fully automated manufacturing infrastructure in operation



More confidence. More success. With Ypsomed Delivery Systems.



UnoPen™ – intuitive disposable pen

Simply dial and dose

The UnoPen™ is an intuitive variable dose pen for insulin and other multidose therapies providing a familiar handling experience and high level of patient acceptance.

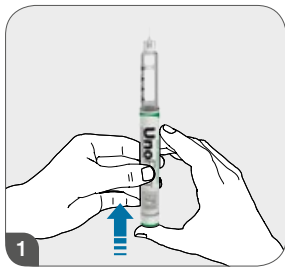

1 Prime

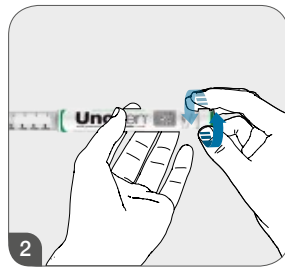

2 Dial dose

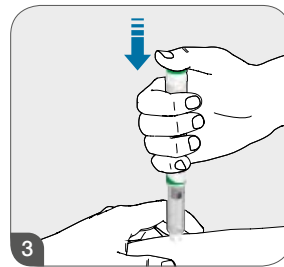

3 Inject



State-of-the-art technology

From the experienced disposable pen company

Handling

- Gearing optimised for maximum force reduction with minimum dose knob extension for optimal user experience
- Large dose display for good readability even for visually impaired patients
- Audible and tactile feedback during dosing, dose correction and delivery to maximise patient confidence
- Pre-injection remaining dose indication for the final dose ensuring correct dosing up to the last unit
- Dial and dose handling concept ensuring a high level of patient acceptance and minimal training effort

Customisation and manufacturing

- UnoPen™ covers a wide range of multidose delivery needs
- Customise UnoPen™ according to your individual primary packaging, drug and therapy needs
- Low unit costs to meet increasing cost pressures
- Off-the-shelf product requiring only low up-front investment by the customer
- Fully automated manufacturing infrastructure in operation



Dose dialing by twisting is intuitive and easy. The gearing mechanism allows a large easy to read display.



UnoPen™ fully automated manufacturing line.



UnoPen™ models

Different drugs require different pens

The UnoPen™ technology is ideally leveraged for use with other hormone-based therapies such as human growth hormone (hGH), follicle stimulating hormone (FSH), parathyroid hormone (PTH) and glucagon-like peptide-1 (GLP-1).



1 **UnoPen™**: Variable dose, ideal for insulin, FSH, hGH

2 **UnoPen™ Fix**: Fixed dose, twist-push injection principle, ideal for PTH, GLP-1



Dimensions and specifications

Facts and figures



Device specifications

Primary container Standard 3 ml and 1.5 ml cartridges according to ISO 11608-3*

Number of dose increments 60 (30 if used with 1.5 ml cartridge)

Min. dose/dose increment 0.01 ml (0.005 ml if used with 1.5 ml cartridge)

Max. dose 0.60 ml (0.30 ml if used with 1.5 ml cartridge)

Compatible needle type Compatible with standard and safety pen needles** – mylife™ Clickfine® and mylife™ Clickfine® AutoProtect™ pen needles recommended

* 3 ml cartridge inner diameter of 9.7 mm recommended

** Pen needles according to ISO 11608-2

3 ml cartridge dimensions (mm)

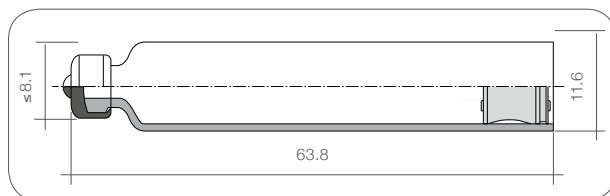

1.5 ml cartridge dimensions (mm)

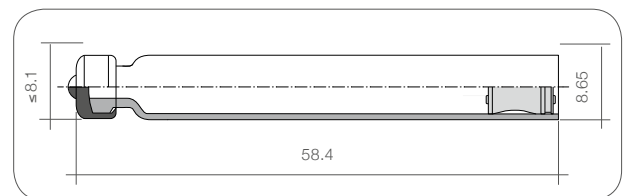

Your delivery system

Drawing on our experience and competence

- Ypsomed has extensive experience in injection device development and manufacturing of more than 30 years and has numerous devices on the market.
- You can expect high quality support for selection of the primary container, customisation of the industrial design, demonstrating dose accuracy and preparing the relevant CTD sections for the registration of the combination product.

More **confidence.**
More **success.**
With **Ypsomed Delivery Systems.**



Pen systems



Autoinjector systems



Patch injector systems



Smart services

Ypsomed Delivery Systems provides a complete range of drug delivery products and services to biopharmaceutical companies. We offer everything from development and design to manufacturing and packaging, giving patients and customers more confidence and leading to more market success.